

Stellfüsse mit Anti-Slip-Platte Swivel Feet with Anti-slip-plate

Preise per 23.02.2025 - Änderungen jederzeit möglich
Prices per 23.02.2025 - may change any time

TSPA

Stellfüsse mit Anti-Slip-Platte Swivel Feet with Anti-slip-plate



Höhenverstellerelemente - Justierstopfen
Height Adjustment Parts - adjusting plugs

Bestellnummer Order number	Ø Ø	H H	F F	SW WAF	Tragkraft kg max. load kg	bis 49 up to 49	ab 50 from 50	ab 100 from 100	ab 500 from 500	ab 1.000 from 1,000
* TSPA 30 M8x25	29	11,5	16,0	13	350	7,4679	5,3445	4,8195	4,3304	3,9010
* TSPA 30 M8x40	29	11,5	16,0	13	350	7,5394	5,4041	4,8672	4,3781	3,9367
* TSPA 30 M8x50	29	11,5	16,0	13	350	7,6230	5,4518	4,9149	4,4258	3,9844
* TSPA 30 M8x70	29	11,5	16,0	13	350	7,7781	5,5831	5,0104	4,5212	4,0680
* TSPA 30 M8x80	29	11,5	16,0	13	350	8,0166	5,7381	5,1774	4,6525	4,1873
* TSPA 30 M8x100	29	11,5	16,0	13	350	8,2433	5,9170	5,3205	4,7956	4,3066
* TSPA 30 M8x120	29	11,5	16,0	13	350	8,6250	6,1914	5,5711	5,0104	4,5094
* TSPA 30 M10x25	29	11,5	16,5	17	470	7,3128	5,2370	4,7123	4,2469	3,8175
* TSPA 30 M10x40	29	11,5	16,5	17	470	7,5394	5,4041	4,8672	4,3781	3,9367
* TSPA 30 M10x50	29	11,5	16,5	17	470	7,5394	5,4041	4,8672	4,3781	3,9367
* TSPA 30 M10x70	29	11,5	16,5	17	470	8,1717	5,8574	5,2728	4,7360	4,2709
* TSPA 30 M10x80	29	11,5	16,5	17	470	8,2433	5,9170	5,3205	4,7956	4,3066
* TSPA 30 M10x100	29	11,5	16,5	17	470	8,8637	6,3584	5,7142	5,1535	4,6287
* TSPA 30 M10x120	29	11,5	16,5	17	470	8,9472	6,4061	5,7619	5,2013	4,6763
* TSPA 30 M12x25	29	11,5	17,5	19	770	7,6230	5,4518	4,9149	4,4258	3,9844
* TSPA 30 M12x40	29	11,5	17,5	19	770	7,7064	5,5233	4,9627	4,4735	4,0203
* TSPA 30 M12x50	29	11,5	17,5	19	770	8,0166	5,7381	5,1774	4,6525	4,1873
* TSPA 30 M12x70	29	11,5	17,5	19	770	9,0306	6,4657	5,8096	5,2370	4,7123
* TSPA 30 M12x80	29	11,5	17,5	19	770	9,1737	6,5851	5,9170	5,3325	4,7956
* TSPA 30 M12x100	29	11,5	17,5	19	770	9,1022	6,5135	5,8693	5,2848	4,7480
* TSPA 30 M12x120	29	11,5	17,5	19	770	10,8201	7,7542	6,9789	6,2749	5,6547
* TSPA 30 M16x40	29	11,5	20,0	24	1450	9,4123	6,7402	6,0721	5,4756	4,9149
* TSPA 30 M16x50	29	11,5	20,0	24	1450	9,5674	6,8475	6,1795	5,5591	4,9985
* TSPA 30 M16x70	29	11,5	20,0	24	1450	10,8201	7,7542	6,9789	6,2749	5,6547
* TSPA 30 M16x100	29	11,5	20,0	24	1450	13,4566	9,6391	8,6847	7,8138	7,0265
* TSPA 30 M16x150	29	11,5	20,0	24	1450	18,5027	13,2775	11,9415	10,7366	9,6629
* TSPA 40 M8x25	39	12,0	16,5	13	350	7,7064	5,5233	4,9627	4,4735	4,0203
* TSPA 40 M8x40	39	12,0	16,5	13	350	7,7781	5,5831	5,0104	4,5212	4,0680
* TSPA 40 M8x50	39	12,0	16,5	13	350	7,8497	5,6307	5,0582	4,5571	4,1038
* TSPA 40 M8x70	39	12,0	16,5	13	350	8,0166	5,7381	5,1774	4,6525	4,1873
* TSPA 40 M8x80	39	12,0	16,5	13	350	8,2433	5,9170	5,3205	4,7956	4,3066
* TSPA 40 M8x100	39	12,0	16,5	13	350	8,4819	6,0721	5,4756	4,9269	4,4377
* TSPA 40 M8x120	39	12,0	16,5	13	350	8,8637	6,3584	5,7142	5,1535	4,6287
* TSPA 40 M10x25	39	12,0	17,0	17	470	7,5394	5,4041	4,8672	4,3781	3,9367
* TSPA 40 M10x40	39	12,0	17,0	17	470	7,7781	5,5831	5,0104	4,5212	4,0680
* TSPA 40 M10x50	39	12,0	17,0	17	470	7,7781	5,5831	5,0104	4,5212	4,0680
* TSPA 40 M10x70	39	12,0	17,0	17	470	8,3984	6,0245	5,4160	4,8791	4,3781
* TSPA 40 M10x80	39	12,0	17,0	17	470	8,4819	6,0721	5,4756	4,9269	4,4377
* TSPA 40 M10x100	39	12,0	17,0	17	470	9,1022	6,5135	5,8693	5,2848	4,7480
* TSPA 40 M10x120	39	12,0	17,0	17	470	9,1737	6,5851	5,9170	5,3325	4,7956
* TSPA 40 M12x25	39	12,0	18,0	19	770	7,8497	5,6307	5,0582	4,5571	4,1038
* TSPA 40 M12x40	39	12,0	18,0	19	770	7,9450	5,6904	5,1059	4,6048	4,1515
* TSPA 40 M12x50	39	12,0	18,0	19	770	8,2433	5,9170	5,3205	4,7956	4,3066
* TSPA 40 M12x70	39	12,0	18,0	19	770	9,2573	6,6328	5,9767	5,3682	4,8434
* TSPA 40 M12x80	39	12,0	18,0	19	770	9,4123	6,7402	6,0721	5,4756	4,9149
* TSPA 40 M12x100	39	12,0	18,0	19	770	9,3288	6,6925	6,0245	5,4160	4,8791
* TSPA 40 M12x120	39	12,0	18,0	19	770	11,0467	7,9093	7,1220	6,4061	5,7619
* TSPA 40 M16x40	39	12,0	20,5	24	1450	9,6391	6,9191	6,2272	5,5949	5,0342
* TSPA 40 M16x50	39	12,0	20,5	24	1450	9,8060	7,0265	6,3226	5,6904	5,1297
* TSPA 40 M16x70	39	12,0	20,5	24	1450	11,0467	7,9093	7,1220	6,4061	5,7619
* TSPA 40 M16x100	39	12,0	20,5	24	1450	13,6952	9,8180	8,8278	7,9570	7,1457
* TSPA 40 M16x150	39	12,0	20,5	24	1450	18,7413	13,4326	12,0846	10,8797	9,7942

* Keine Lagerware, bitte anfragen.

Alle Maße in mm.

Druckfehler, Irrtümer und Änderungen vorbehalten.

Druckfehler und Irrtümer vorbehalten / aktuelle Version siehe

www.plasticmetall.com

Preise in EUR per Stück, netto.

* Not a stock item, please enquire.

All measure specifications in mm.

Printing errors, mistakes and amendments reserved.

Misprint and mistakes excepted / current version see www.plasticmetall.com

EUR prices per piece, netto.

Stellfüsse mit Anti-Slip-Platte Swivel Feet with Anti-slip-plate

Preise per 23.02.2025 - Änderungen jederzeit möglich
Prices per 23.02.2025 - may change any time

Höhenverstellerelemente - Justierstopfen Height Adjustment Parts - adjusting plugs

TSPA

Stellfüsse mit Anti-Slip-Platte
Swivel Feet with Anti-slip-plate

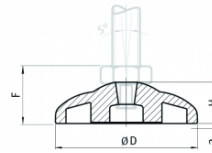

Bestellnummer Order number	Ø Ø	H H	F F	SW WAF	Tragkraft kg max. load kg	bis 49 up to 49	ab 50 from 50	ab 100 from 100	ab 500 from 500	ab 1.000 from 1,000
* TSPA 50 M8x25	50	14,5	19,0	13	350	8,3268	5,9647	5,3682	4,8315	4,3424
* TSPA 50 M8x40	50	14,5	19,0	13	350	8,3984	6,0245	5,4160	4,8791	4,3781
* TSPA 50 M8x50	50	14,5	19,0	13	350	8,4819	6,0721	5,4756	4,9269	4,4377
* TSPA 50 M8x70	50	14,5	19,0	13	350	8,6250	6,1914	5,5711	5,0104	4,5094
* TSPA 50 M8x80	50	14,5	19,0	13	350	8,8637	6,3584	5,7142	5,1535	4,6287
* TSPA 50 M8x100	50	14,5	19,0	13	350	9,1022	6,5135	5,8693	5,2848	4,7480
* TSPA 50 M8x120	50	14,5	19,0	13	350	9,4959	6,7998	6,1198	5,5113	4,9627
* TSPA 50 M10x25	50	14,5	19,5	17	470	8,1717	5,8574	5,2728	4,7360	4,2709
* TSPA 50 M10x40	50	14,5	19,5	17	470	8,3984	6,0245	5,4160	4,8791	4,3781
* TSPA 50 M10x50	50	14,5	19,5	17	470	8,3984	6,0245	5,4160	4,8791	4,3781
* TSPA 50 M10x70	50	14,5	19,5	17	470	9,0306	6,4657	5,8096	5,2370	4,7123
* TSPA 50 M10x80	50	14,5	19,5	17	470	9,1022	6,5135	5,8693	5,2848	4,7480
* TSPA 50 M10x100	50	14,5	19,5	17	470	9,7345	6,9669	6,2749	5,6427	5,0700
* TSPA 50 M10x120	50	14,5	19,5	17	470	9,8060	7,0265	6,3226	5,6904	5,1297
* TSPA 50 M12x25	50	14,5	20,5	19	770	8,4819	6,0721	5,4756	4,9269	4,4377
* TSPA 50 M12x40	50	14,5	20,5	19	770	8,5535	6,1318	5,5233	4,9627	4,4735
* TSPA 50 M12x50	50	14,5	20,5	19	770	8,8637	6,3584	5,7142	5,1535	4,6287
* TSPA 50 M12x70	50	14,5	20,5	19	770	9,8777	7,0742	6,3704	5,7262	5,1654
* TSPA 50 M12x80	50	14,5	20,5	19	770	10,0328	7,1816	6,4657	5,8335	5,2490
* TSPA 50 M12x100	50	14,5	20,5	19	770	9,9493	7,1339	6,4181	5,7739	5,2013
* TSPA 50 M12x120	50	14,5	20,5	19	770	11,6671	8,3627	7,5276	6,7760	6,0961
* TSPA 50 M16x40	50	14,5	23,0	24	1450	10,2713	7,3605	6,6209	5,9647	5,3564
* TSPA 50 M16x50	50	14,5	23,0	24	1450	10,4264	7,4679	6,7283	6,0483	5,4399
* TSPA 50 M16x70	50	14,5	23,0	24	1450	11,6671	8,3627	7,5276	6,7760	6,0961
* TSPA 50 M16x100	50	14,5	23,0	24	1450	14,3154	10,2594	9,2335	8,3149	7,4799
* TSPA 50 M16x150	50	14,5	23,0	24	1450	19,3736	13,8740	12,4902	11,2495	10,1281

Farben
Schwarz, weitere Farben auf Anfrage

Material
Polyamid, glasfaserverstärkt (PA GF); Gewinde verzinkt, auch in Edelstahl lieferbar

Colours
Black, further colours on request

Material
PA6 with 30% glass filled, zinc-plated thread, also available with stainless steel

Hinweise
Nivellierbarer Stellfuss zum Ausgleich von Bodenunebenheiten mit Anti-Slip-Platte. Ohne Anschraubbohrungen. Mindestbestellmenge: 20 Stück Weitere Größen auf Anfrage.

Hints
Levelling foot for stable positioning on slightly uneven floors with Anti-slip-plate. Without Bolt-down Hole. Minimum order: 20 pieces Further sizes on request.

* Keine Lagerware, bitte anfragen.

Alle Maße in mm.

Druckfehler, Irrtümer und Änderungen vorbehalten.

Druckfehler und Irrtümer vorbehalten / aktuelle Version siehe

www.plasticmetall.com

Preise in EUR per Stück, netto.

* Not a stock item, please enquire.

All measure specifications in mm.

Printing errors, mistakes and amendments reserved.

Misprint and mistakes excepted / current version see www.plasticmetall.com

EUR prices per piece, netto.